



## 精密真空减压阀

# RV 系列



## 特长

- **高精度控制** 精度0.13kPa(1mmHg),可以进行反复再现性0.13kPa(±1mmHg)以内的高精度控制。
- **优异的压力特性** 针对进口压力的变化, 设定压力的变化控制在1.3kPa(10mmHg)以内。
- **大流量型号** 流量可以达到270L/min(normal),大流量的用途可以对应。
- **良好的应答性** 针对出口压力的变化可以敏感的应答。

## 用途

最适用于高精度, 大流量的有必要真空控制的用途。

## 规格

	RV·S-1-2	RV-1-2	RV-1-3
使用流体	空气(真空)		
压力设定范围 kPa(mmHg)	-1.3~-100 (-10~-750)		
精度 kPa(mmHg)	0.13 (1)		
反复再现性 kPa(mmHg)	±0.13 (±1)以内		
使用温度范围 °C	5~60		
流量 ℓ/min(ANR)	200	270	
配管连接口径 Rc	1/4		3/8
支架	标准配置		
质量 kg	0.5	0.65	

### <JIS記号>

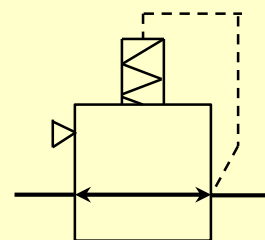



# FUJIKURA COMPOSITES

## 特性

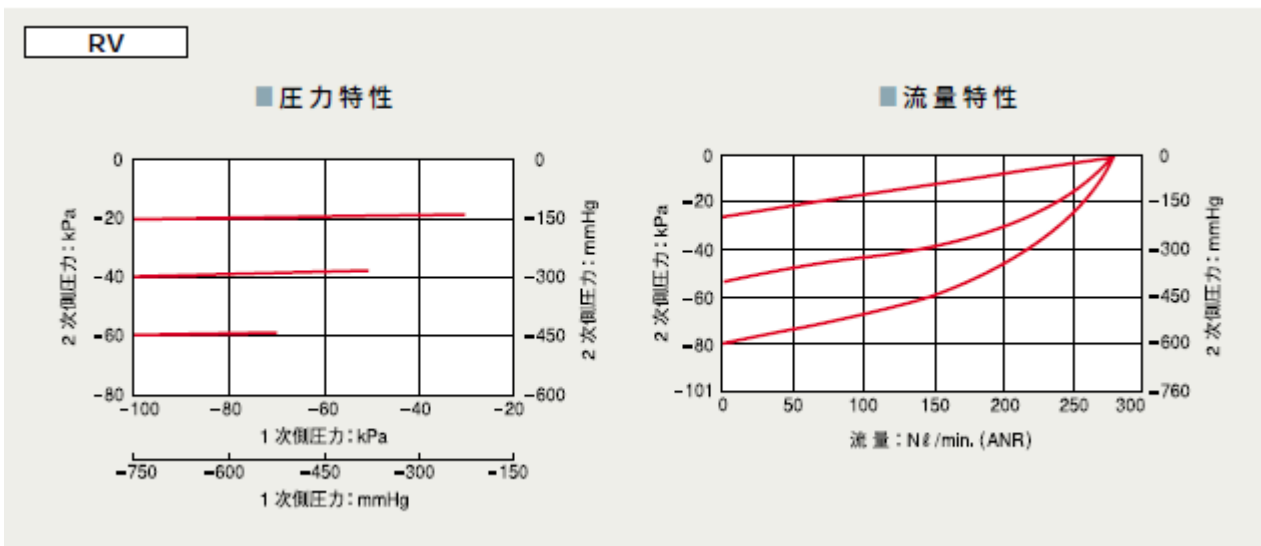
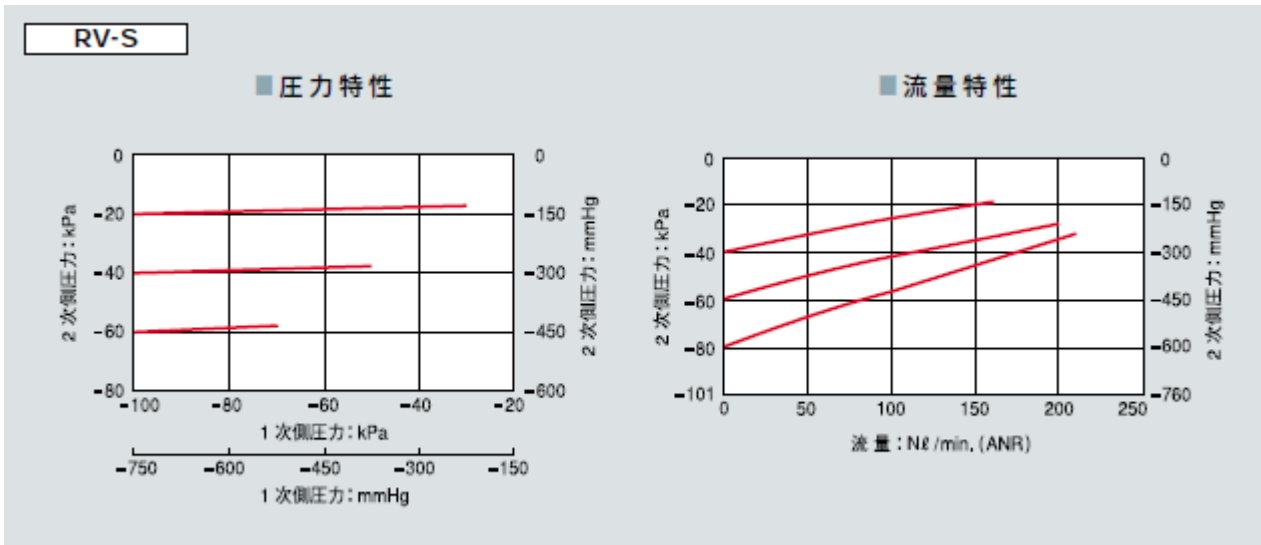

## 型号表示方法

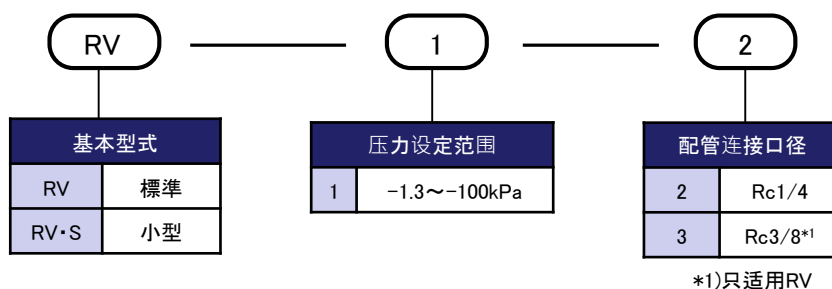



## ■ 外观尺寸

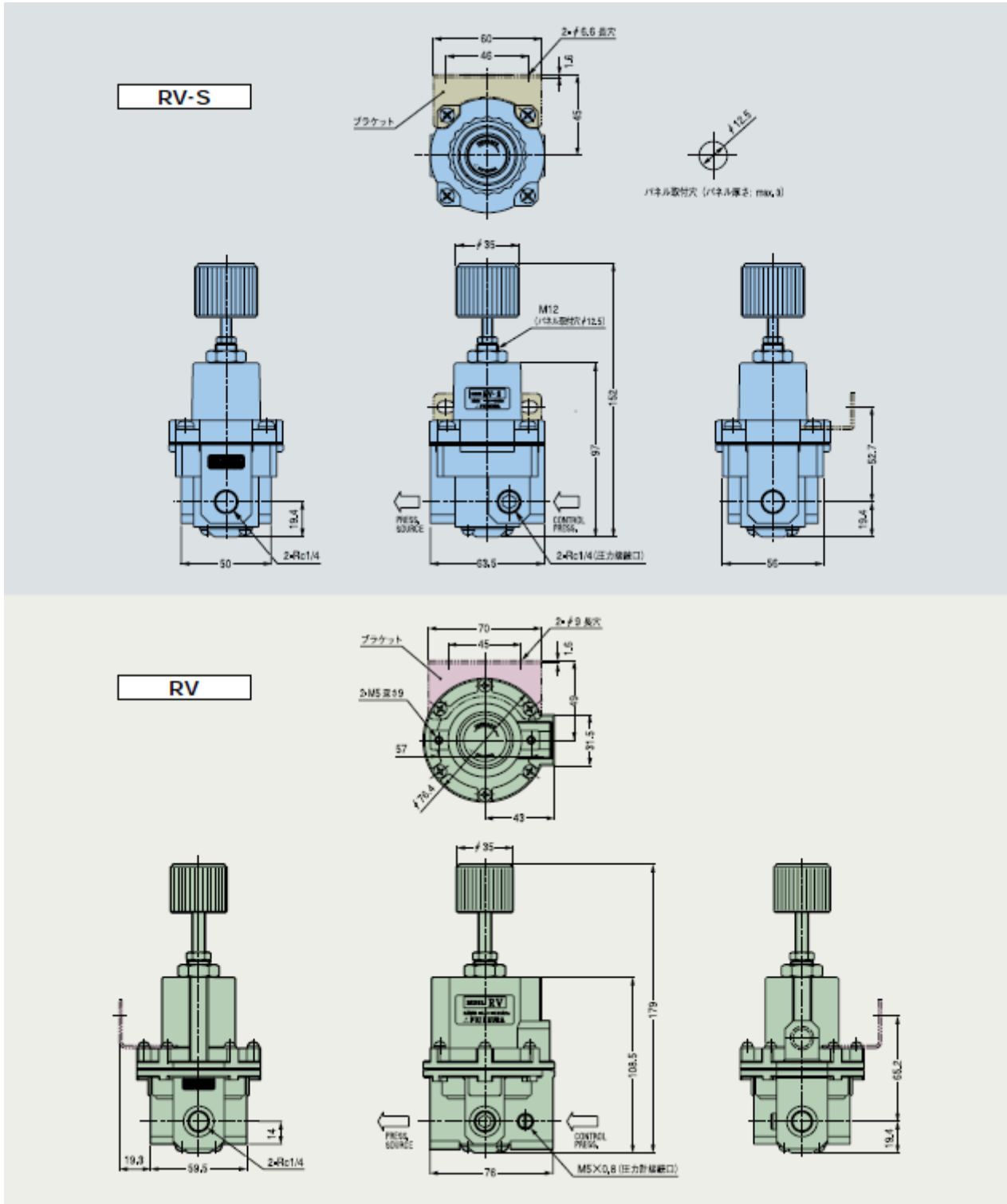

## Notice: Specification changes of Accessory (Bracket for regulator “RV-S series”)

We hereby give official notification that the specifications of the bracket for air regulator “RP series” and “RV series” you have purchased from us are changing from the first lot of production in April 2023. There will be no change in product model number due to this change.

### 【Details of change】

The shape will be changed in accordance with the shared use with other regulator series. Due to the change in shape, the mounting position will also change. There are no changes to the products themselves, so there are no effects on the characteristics.

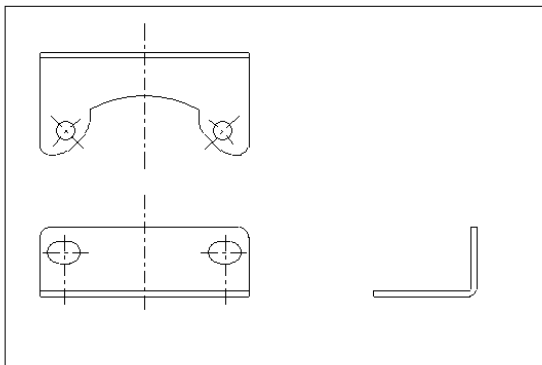

**Bracket**  
Previous model

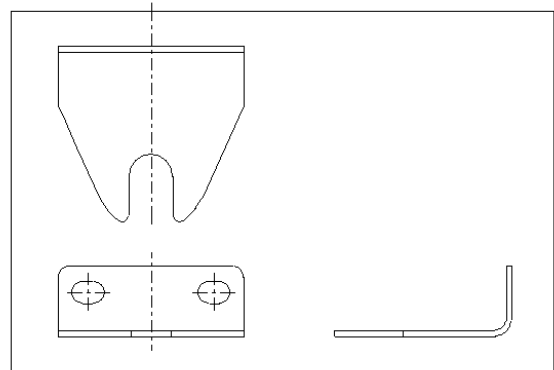

**Bracket**  
New model

### 【RV-S series】

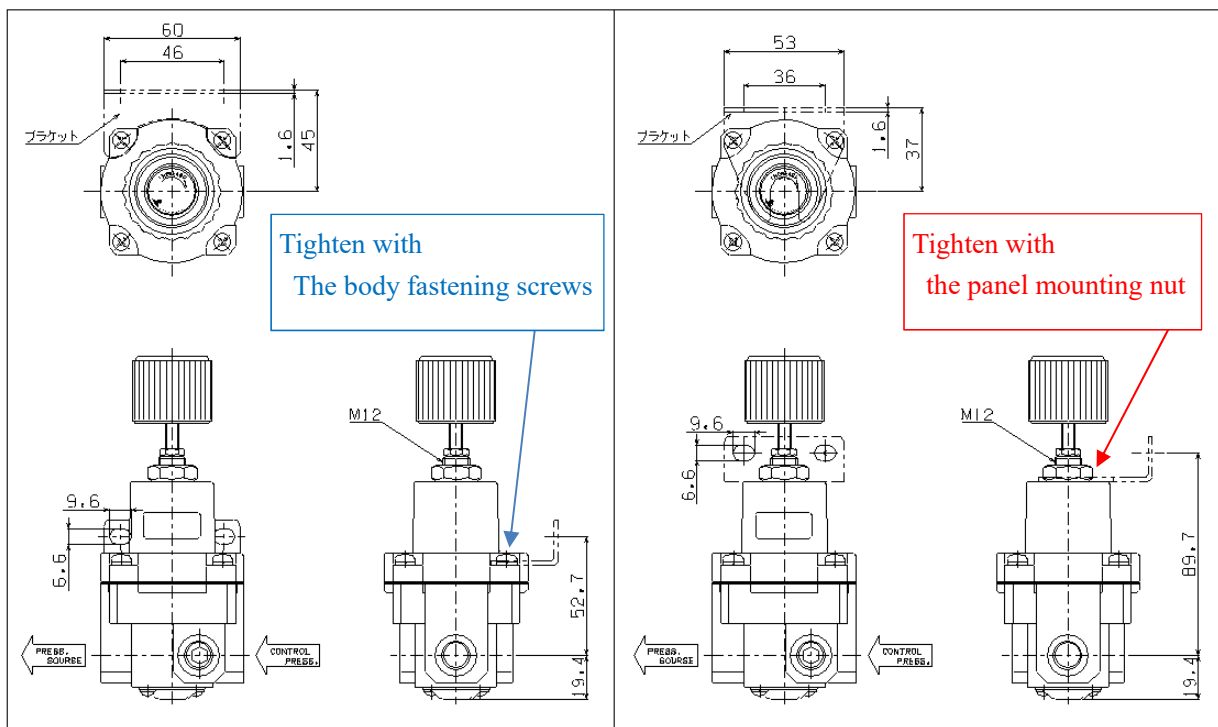

**Assembly Drawing**  
Previous model

**Assembly Drawing**  
New model

管理番号: CES20-22-008E